

En

DEAR CUSTOMER!

You have made an excellent decision. Vitesse® home range offers you an exclusive, high quality range of appliances for your ultimate home luxury and healthy living.

Thank you for choosing Vitesse®. Our products are designed to meet the highest standard of quality, functionality design. We hope you enjoy using your new Vitesse® product. Please read the instructions for use carefully and keep in a safe place for future reference.

CAUTION

Use this appliance only for its intended use as described in this manual. Do not use attachments not recommended by Vitesse®. Do not use this product if it is not working correctly, if it has been dropped or damaged, or dropped into water.

DESCRIPTION

1. On/Off Switch
2. Shaving head with 2 trimmers
3. Guide combs
4. Charging indicator light
5. Charging adaptor
6. Charging stand

GETTING STARTED

Be patient when first using your body trimmer. As with any new product, it may take a little time to familiarize with the product. Take the time to acquaint yourself with your New trimmer, as we are confident you will receive years of enjoyable use and complete satisfaction.

CHARGING YOUR BODY TRIMMER

Before using your body trimmer for the first time, charge for 14-16 hours.

- Ensure the product is switched off.
- Place your body trimmer into the charging stand, connect the charging adaptor to the product and then to the mains. The charging indicator will light up.
- Use product until the battery is low.

Your trimmer cannot be overcharged. However, if the product is not going to be used for an extended period time (2-3 months), unplug it from the mains and store, fully recharge your body trimmer when you would like to use it again.

To preserve the life of your batteries, let them run out every six months then recharge for 14-16 hours.

HOW TO USE

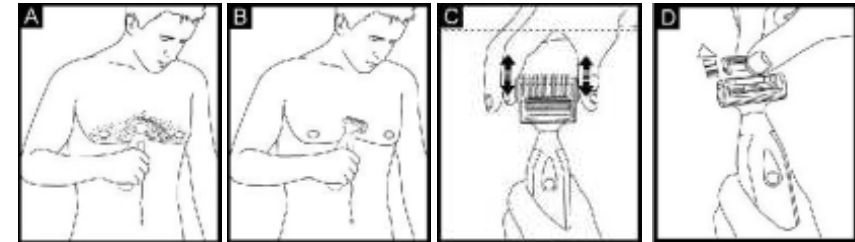

■ **GUIDE COMBS**

The text on the comb indicates the length which the hair will be cut (1.3mm, 2.5 mm & 3.5mm). To attach, gently slide the guide comb on top of the trimmer head and click into position. To remove, carefully lift the side of the comb away from the trimmer head. (Diagram C)

■ **TRIMMING (Diagram A)**

- Attach a guide comb to the trimmer head.
- Turn the unit on.
- Place the flat top of the trimmer comb against the skin.
- Slowly slide the trimmer through the hair, in the direction of hair growth.
- If hair builds up in the guide comb during the trimmer process, the unit off, pull off the guide comb. Brush trimmer/rinse comb.

■ **USING THE SHAVER (Diagram B)**

- Hold the shaving head to your skin.
- Stretch your skin with your free hand so hairs stand upright.
- Only apply light pressure on the shaving head while shaving.
- Shave against hair growth.

CARE FOR YOUR TRIMMER

Care for your product to ensure a long lasting performance. We recommend you clean your shaver after each use. The easiest and the most hygienic way to clean the shaver are by rinsing the product head after use with warm water. Always keep the trimmer in the "off" position when not in use.

■ **AFTER EACH USE**

- Turn Trimmer off.
- Remove the guide comb. (Diagram C)
- Remove the blade and trimmer assembly by placing your fingers either side of the assembly and pulling upwards. (Diagram D)
- Gently shake the blade and trimmer assembly to remove the hair. Brush/rinse the trimmer and shaver housing.
- Replace the blade and trimmer assembly.

NOTE: Never use the cleaning brush on the foil as damage may occur.

CLEANING CAUTIONS

- Cleaning should only be done with a soft brush, such as the brush supplied with the product.
 - Do not use harsh or corrosive cleaners on the units or their cutters.
 - Do not apply pressure or hard objects to cutters.
 - Do not disassemble cutter assembly.
 - Do not submerge in water as damage will occur.
- Suitable for cleaning under water

■ **STORAGE**

- Always store this appliance and cord in a moisture-free area. Do not store it in temperatures exceeding 140°F (60°C).
- Do not wrap the cord of the charging adaptor around the appliance.

IMPORTANT SAFETY INSTRUCTIONS

WARNING TO REDUCE THE RISK OF BURNS, ELECTROCUTION, FIRE, OR INJURY TO PERSONS:

- An appliance should never be left unattended when plugged in to a power outlet.
- Keep the power plug and cord away from heated surfaces.
- Make sure the power plug and cord do not get wet.
- Do not unplug the product with wet hands.
- Do not use the product with a damaged cord.
- Use and store the product at a temperature between 15°C and 35°C.
- Always unplug from the mains when cleaning.
- Only use the parts supplied with the appliance.
- This product is for cordless use only. Do not use your Trimmer while it is plugged into the mains.
- Keep this product out of reach of children. The use of this appliance by persons with reduced physical, sensory or mental capabilities or lack of experience and knowledge can give cause to hazards. Persons responsible for their safety should give explicit instructions or supervise the use of the appliance.

PROTECT THE ENVIRONMENT

The product contains a Ni-CD cell unit. Do not dispose of the trimmer in household waste at the end of its useful life.

CAUTION: Do not put in fire or mutilate your battery packs as they may burst or release toxic materials.

BATTERY REMOVAL

To remove the battery for safe disposal, please follow the instructions below:

- Turn the trimmer on and discharge all remaining power.
- Use a small screwdriver to remove the blue side panels.
- Push in the small clips at the bottom of the trimmer (one on each side) and separate the top and bottom housing.
- Unscrew and separate the top and bottom battery housing.
- Cut the connection wire and remove the PCB assembly.
- Remove the battery and dispose of correctly.

Technical Data

Power AC: 230V~50 Hz;
Output: DC 3V, 800mA

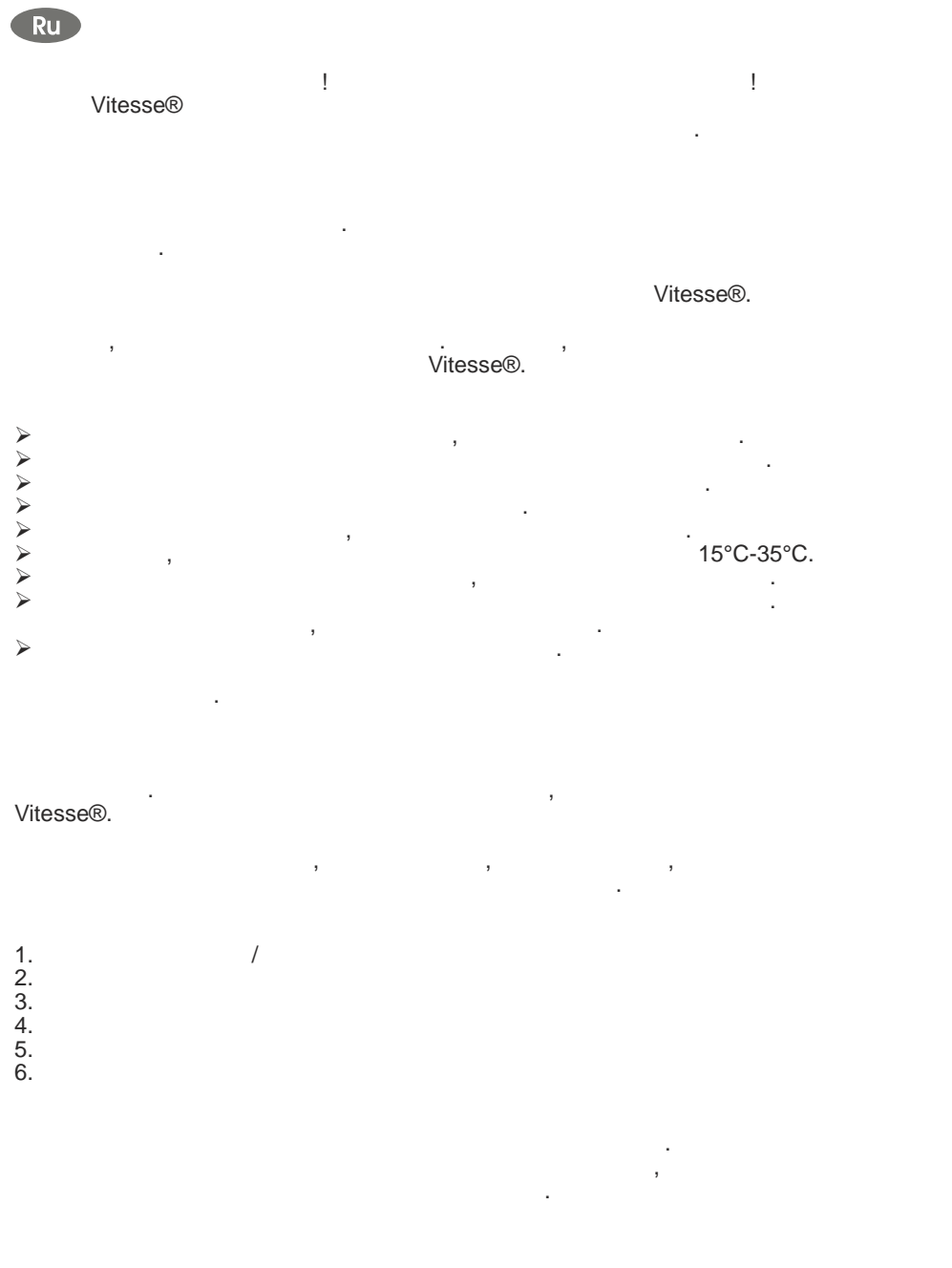

14-
16
(2-3),
14 16 6

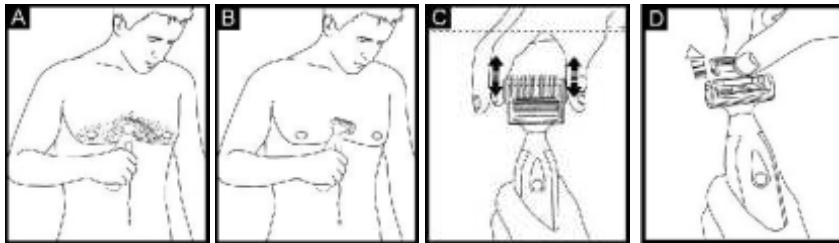

(1.3 ,2.5 3.5).
(C)

(A)

(B)

“ ”
().
(D).
60°C.
Ni-CD
)

:AC:230 ~50
:DC3 ,800